

## FORTIS LINE Side Panel, 1000mm, clear glass



**Order code:** FL3510

### Basic information

**Brand:** Polysan  
**Series:** FORTIS LINE

### Size

**Width:** 1000 mm  
**Height:** 2000 mm

### Properties

**Color profile:** Chrome - Brushed aluminum  
**Shape:** Fixed wall for shower door  
**Glass colour:** TRANSPARENT glass  
**Glass finish:** Antidrop  
**Glass thickness:** 8 mm  
**Weight / Piece:** 43.0 kg  
**Packing:** 1 Piece  
**Guarantee:** 2 years



## Technical sheet

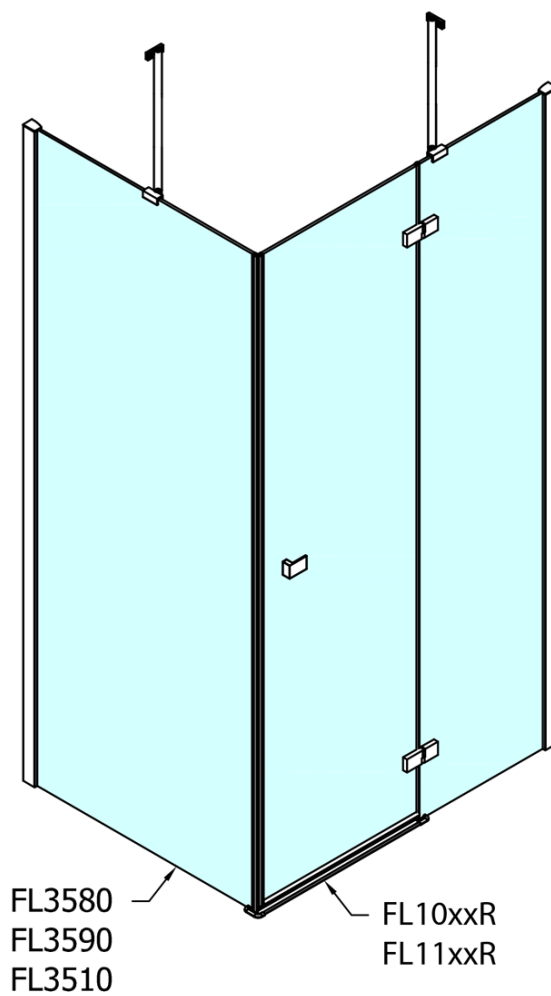
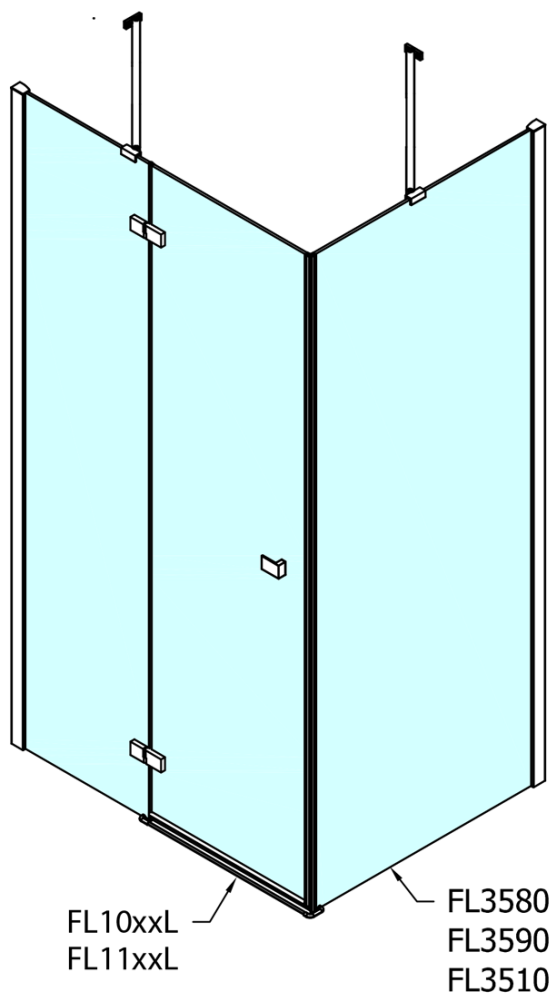

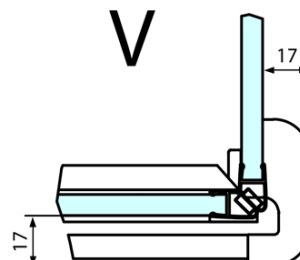
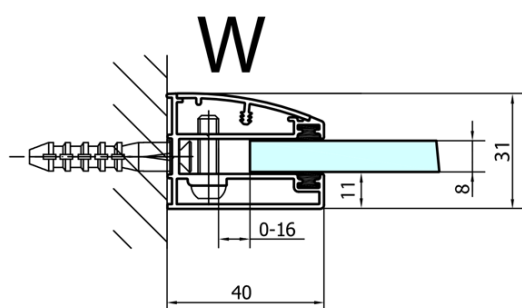
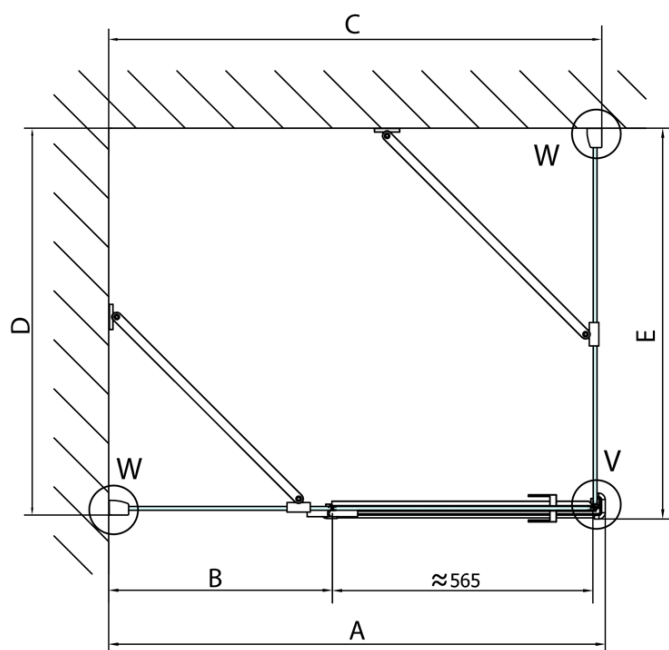

Dveře	A (mm)	B (mm)	C (mm)
FL1080	785-801	≈ 200	779-795
FL1090	885-901	≈ 300	879-895
FL1010	985-1001	≈ 400	979-995
FL1011	1085-1101	≈ 500	1079-1095
FL1012	1185-1201	≈ 600	1179-1195
FL1113	1285-1301	≈ 700	1279-1295
FL1114	1385-1401	≈ 800	1379-1395
FL1115	1485-1501	≈ 900	1479-1495

Boční stěna	E	D
FL3580	785-801	779-795
FL3590	885-901	879-895
FL3510	985-1001	979-995